



1.0 PRODUCT DESCRIPTION

Available Sizes:

- 1 ½ – 3"/DN40 – DN80

Maximum Working Pressure:

- Fitting pressure ratings are equivalent to the pressure ratings of the coupling used to install them. Coupling pressure ratings are pipe wall thickness dependent.

Function:

- Connects pipe sections, provides change in direction, and adapts sizes or components.

All fittings are supplied with Victaulic Original Groove System (OGS) grooves. Fittings are exclusively for use with Victaulic couplings, valves, accessories and pipe which feature ends containing the Victaulic OGS groove profile

Codes and requirements:

- Support hanger spacing correspond to ASME B31.1 Power Piping Code and ASME B31.9 Building Services Piping Code

2.0 CERTIFICATION/LISTINGS

Product designed and manufactured under Victaulic's Quality Management System, as certified by LPCB in accordance with ISO-9001:2015.

3.0 MATERIAL SPECIFICATIONS

Schedule 40S Material Specifications:

Elbows:

1 ½ – 3"/DN40 – DN80 90° and 45° Elbows available in Schedule 40S, Grade CE3MN Grade 5 (super duplex stainless steel) conforming to A890 and A995.

Tees & Reducing Tees:

2 – 3"/DN50 – DN80 Tees & 3 x 2 ½"/DN80 x 65 mm Reducing Tees available in Schedule 40S, Grade CE3MN Grade 5 (super duplex stainless steel) conforming to A890 and A995.

Caps: (specify choice)

Standard: Duplex Grades UNS S31803 or S32205 plate conforming to ASTM A240.

Optional: Super Duplex Grade UNS S32750 plate conforming to ASTM A240.

ALWAYS REFER TO ANY NOTIFICATIONS AT THE END OF THIS DOCUMENT REGARDING PRODUCT INSTALLATION, MAINTENANCE OR SUPPORT.

4.0 DIMENSIONS

Elbows

No. 410DX 90° Long Radius Elbow

No. 411DX 45° Elbow

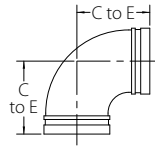

No. 410DX

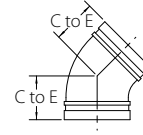

No. 411DX

Size		No. 410DX 90° Elbow		No. 411DX 45° Elbow	
Nominal inches DN	Actual Outside Diameter inches mm	C to E inches mm	Approx. Weight Each lb kg	C to E inches mm	Approx. Weight Each lb kg
1½ DN40	1.900 48.3	3.50 89	1.5 0.7	2.50 64	1.2 0.6
2 DN50	2.375 60.3	4.38 111	2.5 1.1	2.75 70	1.8 0.8
2½	2.875 73.0	5.13 130	4.1 1.8	3.13 79	2.9 1.3
3 DN80	3.500 88.9	5.88 149	6.7 3.0	3.38 86	4.5 2.0

Tees

No. 420DX

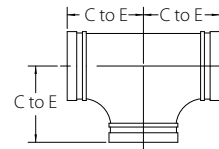

No. 420DX

Size		No. 420DX Tee		
Nominal inches DN	Actual Outside Diameter inches mm	C to E inches mm	Approx. Weight Each lb kg	
2 DN50	2.375 60.3	3.25 83	3.1 1.4	
2½	2.875 73.0	3.75 95	5.7 2.6	
3 DN80	3.500 88.9	4.25 108	8.5 3.8	

4.0 DIMENSIONS (CONTINUED)

Reducing Tees

No. 425DX

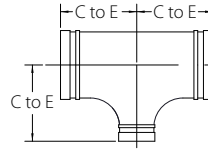

No. 425DX

Nominal Size inches DN	Actual Outside Diameter inches mm	No. 425DX Grooved Branch Reducing Tee		
		C to E Run inches mm	C to E Branch inches mm	Approx. Weight Each lb kg
3 DN80 x 3 DN80 x 2½	3.500 88.9 x 3.500 88.9 x 2.875 73.0	4.25 108	4.25 108	8.1 3.7

Cap

No. 460DX

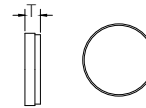

No. 460DX

Size		No. 460DX (Flat) Cap		
Nominal inches DN	Actual Outside Diameter inches mm	Thickness "T" inches mm	Maximum Tap Size inches	Approx. Weight Each lb kg
1½ DN40	1.900 48.3	1.00 25	¾ DN20	0.7 0.3
2 DN50	2.375 60.3	1.00 25	1 DN25	1.2 0.5
2½	2.875 73.0	1.00 25	1½ DN40	2.9 1.3
3 DN80	3.500 88.9	1.00 25	2 DN50	2.6 1.2

NOTE

- End caps are available with an NPT/BSPT tapped port. Contact Victaulic for more information.

5.0 PERFORMANCE

Not Applicable

6.0 NOTIFICATIONS

WARNING



- Read and understand all instructions before attempting to install any Victaulic piping products.
- Always verify that the piping system has been completely depressurized and drained immediately prior to installation, removal, adjustment, or maintenance of any Victaulic products.
- Confirm that any equipment, branch lines, or sections of piping that may have been isolated for/during testing or due to valve closures/positioning are identified, depressurized, and drained immediately prior to installation, removal, adjustment, or maintenance of any Victaulic products.
- Wear safety glasses, hardhat, and foot protection.
- It is the system designer's responsibility to verify suitability of stainless steel flexible hose for use with the intended fluid media within the piping system and external environment.
- The material specifier shall evaluate the effect of chemical composition, pH level, operating temperature, chloride level, oxygen level, and flow rate on stainless steel components to confirm system life will be acceptable for the intended service.

Failure to follow these instructions could compromise system integrity or cause system failure, resulting in death or serious personal injury and property damage.

7.0 REFERENCE MATERIALS

[05.01: Seal Selection Guide](#)

[I-100: Victaulic Field Installation Instruction Handbook](#)

[I-ENDCAP: Victaulic End Caps Installation Instructions](#)

User Responsibility for Product Selection and Suitability

Each user bears final responsibility for making a determination as to the suitability of Victaulic products for a particular end-use application, in accordance with industry standards and project specifications, as well as Victaulic performance, maintenance, safety, and warning instructions. Nothing in this or any other document, nor any verbal recommendation, advice, or opinion from any Victaulic employee, shall be deemed to alter, vary, supersede, or waive any provision of Victaulic Company's standard conditions of sale, installation guide, or this disclaimer.

Intellectual Property Rights

No statement contained herein concerning a possible or suggested use of any material, product, service, or design is intended, or should be construed, to grant any license under any patent or other intellectual property right of Victaulic or any of its subsidiaries or affiliates covering such use or design, or as a recommendation for the use of such material, product, service, or design in the infringement of any patent or other intellectual property right. The terms "Patented" or "Patent Pending" refer to design or utility patents or patent applications for articles and/or methods of use in the United States and/or other countries.

Note

This product shall be manufactured by Victaulic or to Victaulic specifications. All products to be installed in accordance with current Victaulic installation/assembly instructions. Victaulic reserves the right to change product specifications, designs and standard equipment without notice and without incurring obligations.

Installation

Reference should always be made to the Victaulic installation handbook or installation instructions of the product you are installing. Handbooks are included with each shipment of Victaulic products, providing complete installation and assembly data, and are available in PDF format on our website at www.victaulic.com.

Warranty

Refer to the Warranty section of the current Price List or contact Victaulic for details.

Trademarks

Victaulic and all other Victaulic marks are the trademarks or registered trademarks of Victaulic Company, and/or its affiliated entities, in the U.S. and/or other countries.