

# Style 994 Vic-Flange® Adapter For HDPE Pipe

## PRODUCT DESCRIPTION

Style 994 HDPE flange adapter for HDPE pipe permits direct connection of ANSI Class 125 and 150 flanged components into HDPE systems. No fused adapters are required. The housing bolts onto the pipe end with sharp teeth to grip the pipe with tongue-and-groove for positive axial alignment. The Style 994 gasket seals on the pipe O.D. and directly to the flange face. No standard flange gasket is required.



APPROVED

Contact Victaulic for details.

## DIMENSIONS

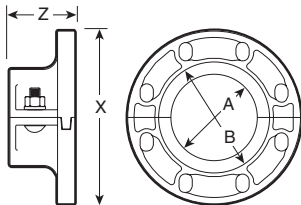

Pipe Size		Draw Bolt/Nut No. - Size Inches §	Flange Bolt/Nut No. - Size Inches † ‡	Dimensions Inches/millimeters				Approx. Weight Each Lbs./kg
Nominal Diameter In./mm	Actual Outside Diameter In./mm			X	Z	Sealing Surface*		
						A - min.	B - max.	
4 100	4.500 114,3	2 - 5/8 X 1 3/4	8 - 5/8 X 3	9.00 229	3.38 86	4.50 114	5.78 147	12.5 5,7
6 150	6.625 168,3	2 - 3/4 X 2 1/4	8 - 3/4 X 3 1/2	11.00 279	4.00 102	6.63 168	7.97 202	17.3 7,8
8 200	8.625 219,1	2 - 3/4 X 2 1/4	8 - 3/4 X 3 1/2	13.50 343	4.50 114	8.63 220	10.00 254	30,8 14,0

§ Supplied with Style 994 Vic-Flange Adapter.

† Total bolts required, to be supplied by installer.

‡ Bolt sizes for conventional flange-to-flange connection. Larger bolts required when Vic-Flange adapter is utilized with wafer-type valves.

\* Minimum/maximum sealing surface on mating flange must be available for proper gasket seating. Entire area must be flat. Heavy serrated (phonograph record) finishes are not acceptable. When used with rubber seated wafer butterfly valves, a flat metal adapter plate is needed.

## PERFORMANCE

Victaulic HDPE products are designed to mechanically join HDPE (\*high density polyethylene/ polybutylene conforming to ASTM D-2447, D-3000, D-3035 or F-714) pipe of wall thicknesses from SDR 32.5 to 7.3. Victaulic HDPE products have integral rows of gripping teeth in each side of the housing which bite into HDPE pipe around the entire circumference. This eliminates special heat fusion, solvent joining or special adapters. **Victaulic HDPE products are not intended for use on PVC pipe or other materials. Victaulic lubricant should not be used with HDPE pipe.**

HDPE pipe brands we have tested indicate that the working pressure of Victaulic HDPE products are dictated by the working pressure of the pipe. The pipe manufacturers listing is dependent upon wall thicknesses, pipe composition and temperature. Pipe tolerances shown in the charts are \*at +70°F (+21°C) and for rigid pipe with SDR of 20 or lower.

\*At ambient temperatures.

 <b>WARNING</b>	
<ul style="list-style-type: none"> <li>• <b>Victaulic Style 994 flange adapters are qualified for use on HDPE ONLY. These products should not be used on other plastic materials.</b></li> <li>• <b>Failure to follow this instruction could result in serious personal injury, improper installation, leakage or joint separation.</b></li> </ul>	

Pipe Size		Dimensions Inches/millimeters		
Nominal Diameter In./mm	Actual Outside Diameter In./mm	Outside Diameter		Maximum Out of Round Tolerance *
		Size	Tolerance *	
4 100	4.500 114,3	4.500 114,3	± 0.020 0,508	± 0.040 1,016
6 150	6.625 168,3	6.625 168,3	± 0.030 0,762	± 0.050 1,270
8 200	8.625 219,1	8.625 219,1	± 0.039 0,990	± 0.075 1,905

\*At ambient temperatures.

## MATERIAL SPECIFICATIONS

**Housing:** Ductile iron conforming to ASTM A-536, grade 65-45-12. Ductile iron conforming to ASTM A-395, grade 65-45-15, is available upon special request.

**Housing Coating:** Orange enamel

- **Optional:** Hot dip galvanized
- **Optional:** Zinc electroplated

**Gasket:** (specify choice\*)

• **Grade “E” EPDM**

EPDM (Green color code). Temperature range –30°F to +230°F (–34°C to +110°C). Recommended for cold and hot water service within the specified temperature range plus a variety of dilute acids, oil-free air and many chemical services. UL classified in accordance with ANSI/NSF 61 for cold +86°F (+30°C) and hot +180°F (+82°C) potable water service. **NOT RECOMMENDED FOR PETROLEUM SERVICES.**

• **Grade “T” nitrile**

Nitrile (Orange color code). Temperature range –20°F to +180°F (–29°C to +82°C). Recommended for petroleum products, air with oil vapors, vegetable and mineral oils within the specified temperature range. Not recommended for hot water services over +150°F (+66°C) or for hot dry air over +140°F (+60°C).

\*Services listed are General Service Recommendations only. It should be noted that there are services for which these gaskets are not recommended. Reference should always be made to the latest Victaulic Gasket Selection Guide for specific gasket service recommendations and for a listing of services which are not recommended.

**Bolts/Nuts/Washers:** Heat-treated plated carbon steel, trackhead meeting the physical and chemical requirements of ASTM A-449 and physical requirements of ASTM A-183. Hardened steel flat washers meeting ASTM F-436, Type 3 requirements.

- **Optional:** Type 304 or 316 stainless steel.

This product shall be manufactured by Victaulic Company. All products to be installed in accordance with current Victaulic installation/assembly instructions. Victaulic reserves the right to change product specifications, designs and standard equipment without notice and without incurring obligations.