

Supplemental Alarm Kit

SERIES 75B



SEE VICTAULIC PUBLICATION 10.01 FOR DETAILS

The Series 75B Supplemental Alarm Device is designed for use with Series 756 Dry Valves, Series 758 Preaction Valves (equipped with mechanical alarms), and FireLock NXT Series 768 and 769 Valves to provide a continuous alarm. The Series 75B is fully rated to 300 psi service and can easily be retrofitted to any size valve.

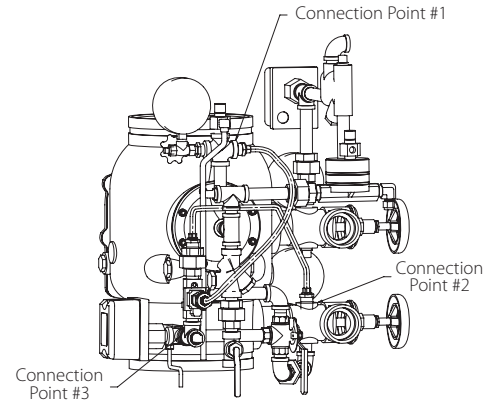

OPERATION

The Series 75B supplemental alarm will ensure that the mechanical alarm continues even if the clapper closes and water fills above it in the system. In the normal set condition, the upper chamber pressure of the Series 75B creates a greater force than the lower chamber pressure; therefore, no water will flow through the Series 75B. When the control valve actuates, pressure in the charge line will fall below 5 psi/34 kPa and will cause the Series 75B to open. Water will then flow to the water motor alarm continuously until the supply water is stopped. Easily added to pre-existing 1/2" trim on preaction and dry valves, the Series 75B does not require operator set-up or maintenance.

NOTE: Series 75B is not required and is not recommended for use on Series 751 Alarm valves, Series 758 Deluge valves, or Series 769 Deluge valves.

MATERIAL SPECIFICATIONS

Hose: 1/2" 304 Stainless steel flexible braided

Trim and Nipples: Galvanized steel

Pilot Valve: Brass

JOB/OWNER

System No. _____
Location _____

CONTRACTOR

Submitted By _____
Date _____

ENGINEER

Spec Sect _____ Para _____
Approved _____
Date _____

Supplemental Alarm Kit

SERIES 75B

SERIES 75B SUPPLEMENTAL ALARM DEVICE ASSEMBLY DRAWING

The Series 75B is designed for use only with systems using a water motor gong as the alarm device.

Series 756 Dry/Series 758 Preaction Only

Item	Qty.	Description
1	2	Elbow (1/2" NPT Female, 90°)
2	1	Hose Assembly (2-foot length)
3	4	Close Nipple (1/4" NPT x .88)
4	3	Close Nipple (1/2" NPT x 1.13)
5	1	Series 75B Supplemental Alarm Device
6	1	Pipe Plug (1/4" NPT)
7	1	Pipe Plug (1/2" NPT)
8	1	Hose Assembly (1-foot length)
9	4	Reducing Bushing (1/2" NPT x 1/4" NPT)
10	1	Tee (1/4" NPT Female)
11	1	Tee (1/2" NPT Female)
12	2	Union (1/2" NPT)

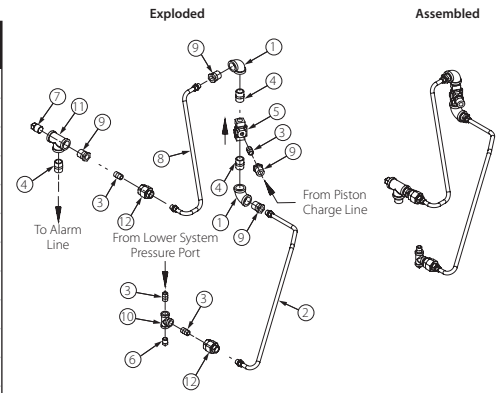

Series 768 NXT Dry/Series 769 NXT Preaction Only

Item	Qty.	Description
1	2	Hose Assembly (1/4" NPT x 24")
2	3	Close Nipple (1/2" NPT x 1.13)
3	1	Pipe Plug (1/2" NPT)
4	3	Reducing Bushing (1/2" NPT x 1/4" NPT)
5	1	Supplemental Alarm Valve 758
6	1	Tee (1/2" NPT Female)
7	1	Union (1/2" NPT)
8	1	Close Nipple (1/4" NPT)
9	1	Union (1/4" NPT)

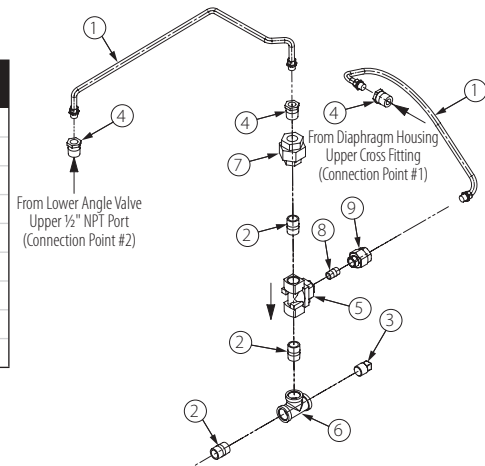

WARRANTY

Refer to the Warranty section of the current Price List or contact Victaulic for details.

NOTE

This product shall be manufactured by Victaulic or to Victaulic specifications. All products to be installed in accordance with current Victaulic installation/assembly instructions. Victaulic reserves the right to change product specifications, designs and standard equipment without notice and without incurring obligations.



For complete contact information, visit www.victaulic.com

30.33 3501 REV B UPDATED 11/2006

VICTAULIC IS A REGISTERED TRADEMARK OF VICTAULIC COMPANY. © 2006 VICTAULIC COMPANY. ALL RIGHTS RESERVED. PRINTED IN THE USA..

