



1.0 PRODUCT DESCRIPTION

Available Sizes

- Grooved Inlet: 1 ½"/DN40, 2 ½"/73.0mm
- National Hose Thread Outlet: 2 ½"/DN40

Maximum System Working Pressure

- Up to 300 psi/2068 kPa/21 Bar

Function

- Utilized downstream of pressure reducing control valves when present at multi-story building floor control assemblies
- May also be utilized to validate appropriate outlet pressure setting of a PRV during initial install.
- Eliminates the need to use multiple fittings and standard hose valves for testing.

Accessories:

- Series GFTA (Groove x Female Thread Adapter) available in 2 ½"/DN40, features a swivel type female hose connection and comes equipped with a plug and chain. Utilized for connecting a 2 ½"/DN40 hose from the Series FTV Flow Test Valve to a gang drain.

2.0 CERTIFICATION/LISTINGS

Product designed and manufactured under the Victaulic Quality Management System, as certified by LPCB in accordance with ISO-9001:2015.

3.0 SPECIFICATIONS – MATERIAL

Valve Body: Brass

Cover: Brass

Seat: PTFE

Ball: Brass

Stem: Brass

Stem Packing: PTFE

Gland Nut: Brass

Lever & Grip: Steel

Lever Nut: Steel

Cap: Brass

ALWAYS REFER TO ANY NOTIFICATIONS AT THE END OF THIS DOCUMENT REGARDING PRODUCT INSTALLATION, MAINTENANCE OR SUPPORT.

4.0 DIMENSIONS

Series FTV Flow Test Valve

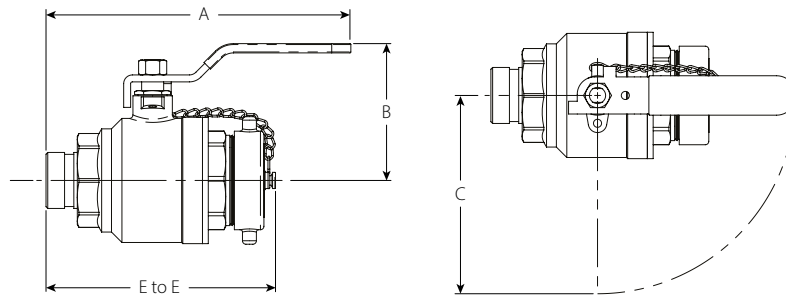

Size		Dimensions				Weight
Nominal inches DN	Actual Outside Diameter inches mm	E to E inches mm	A inches mm	B inches mm	C inches mm	Approximate (Each) lb kg
1 ½ DN40	1.900 48.3	7.75 197	10.38 264	4.63 117	6.75 171	9.6 4.4
2 ½	2.875 73.0	7.75 197	10.38 264	4.63 117	6.75 171	9.5 4.3

Series GFTA Groove x Female Thread Adapter

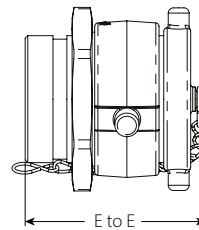

Size		Dimension	Weight
Nominal inches DN	Actual Outside Diameter inches mm	E to E inches mm	Approximate (Each) lb kg
2 ½	2.875 73.0	4.13 105	3.6 1.6

5.0 PERFORMANCE

Nominal inches DN	Actual Outside Diameter inches mm	Maximum Working Pressure psi kPa
1 ½ DN40	1.900 48.3	300 2068
2 ½	2.875 73.0	300 2068

6.0 NOTIFICATIONS

WARNING



- Read and understand all instructions before attempting to install any Victaulic products.
- Always verify that the piping system has been completely depressurized and drained immediately prior to installation, removal, adjustment, or maintenance of any Victaulic products.
- Wear safety glasses, hardhat, and foot protection.

Failure to follow these instructions could result in death or serious personal injury and property damage.

- These products shall be used only in fire protection systems that are designed and installed in accordance with current, applicable National Fire Protection Association (NFPA 13, 13D, 13R, etc.) standards, or equivalent standards, and in accordance with applicable building and fire codes. These standards and codes contain important information regarding protection of systems from freezing temperatures, corrosion, mechanical damage, etc.
- The installer shall understand the use of this product and why it was specified for the particular application.
- The installer shall understand common industry safety standards and potential consequences of improper product installation.
- It is the system designer's responsibility to verify suitability of materials for use with the intended fluid media within the piping system and external environment.
- The material specifier shall evaluate the effect of chemical composition, pH level, operating temperature, chloride level, oxygen level, and flow rate on materials to confirm system life will be acceptable for the intended service.

Failure to follow installation requirements and local and national codes and standards could compromise system integrity or cause system failure, resulting in death or serious personal injury and property damage.

7.0 REFERENCE MATERIALS

[10.64: FireLock™ Installation-Ready™ Rigid Couplings Style 009N and Style 109](#)

User Responsibility for Product Selection and Suitability

Each user bears final responsibility for making a determination as to the suitability of Victaulic products for a particular end-use application, in accordance with industry standards and project specifications, as well as Victaulic performance, maintenance, safety, and warning instructions. Nothing in this or any other document, nor any verbal recommendation, advice, or opinion from any Victaulic employee, shall be deemed to alter, vary, supersede, or waive any provision of Victaulic Company's standard conditions of sale, installation guide, or this disclaimer.

Intellectual Property Rights

No statement contained herein concerning a possible or suggested use of any material, product, service, or design is intended, or should be construed, to grant any license under any patent or other intellectual property right of Victaulic or any of its subsidiaries or affiliates covering such use or design, or as a recommendation for the use of such material, product, service, or design in the infringement of any patent or other intellectual property right. The terms "Patented" or "Patent Pending" refer to design or utility patents or patent applications for articles and/or methods of use in the United States and/or other countries.

Note

This product shall be manufactured by Victaulic or to Victaulic specifications. All products to be installed in accordance with current Victaulic installation/assembly instructions. Victaulic reserves the right to change product specifications, designs and standard equipment without notice and without incurring obligations.

Installation

Reference should always be made to the Victaulic installation handbook or installation instructions of the product you are installing. Handbooks are included with each shipment of Victaulic products, providing complete installation and assembly data, and are available in PDF format on our website at www.victaulic.com.

Warranty

Refer to the Warranty section of the current Price List or contact Victaulic for details.

Trademarks

Victaulic and all other Victaulic marks are the trademarks or registered trademarks of Victaulic Company, and/or its affiliated entities, in the U.S. and/or other countries.