

Actuator Adapter Kit for Installation-Ready™ Butterfly Valves

⚠ WARNING



- Read and understand all instructions contained in this kit installation sheet and in the I-120 installation manual before proceeding.
- Prevent flow from passing through the valve, and place the disc in the “shut” position during the following procedures.
- Wear safety glasses, hardhat, and foot protection.

Failure to follow these instructions could result in death or serious personal injury and property damage.

EXPLODED VIEW OF ACTUATOR ADAPTER KIT

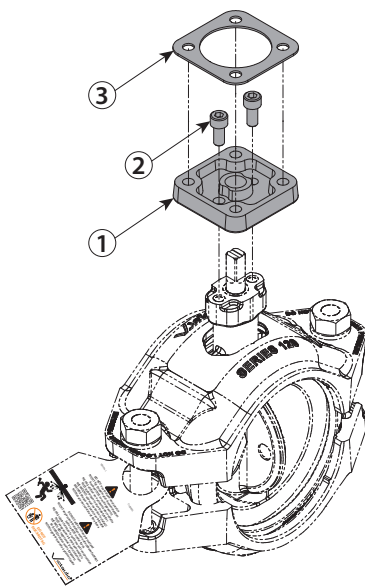

2"/DN50, 2 1/2", DN65, 3"/DN80, AND 4"/DN100 SIZE CONFIGURATIONS SHOWN ABOVE

Item	Quantity for 2"/DN50, 2 1/2", DN65, 3"/DN80, and 4"/DN100 Sizes	Quantity for DN125, 6"/DN150, and 8"/DN200 Sizes	Description
1	1	1	Actuator Adapter Plate
2	2	4	Cap Screw
3	1	1	Thermal Barrier

REMOVAL OF LEVER LOCK HANDLE COMPONENTS

Removal of the lever lock handle can be performed without removing the valve from the piping system. **Prevent flow from passing through the valve during removal of the lever lock handle.**

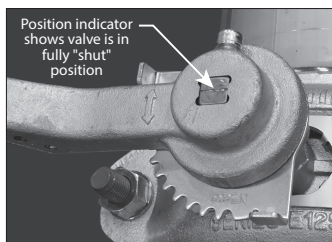

1. Using the lever lock handle, place the valve in the fully “shut” position. **NOTE:** There is a position indicator on top of the stem.



2. Remove the set screw from the side of the lever lock handle.

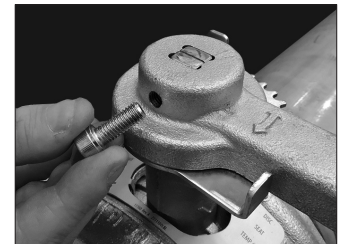

3. Remove the lever lock handle from the lever lock handle plate.

⚠ CAUTION

- **DO NOT** attempt to operate an Installation-Ready™ Butterfly Valve without a lever lock handle or actuator installed. Failure to follow this instruction will cause improper valve operation and damage to the stem.



4. Remove the two cap screws and washers, then remove the lever lock handle plate.

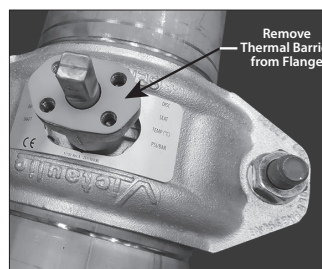

5. Remove the thermal barrier from the flange.

Actuator Adapter Kit for Installation-Ready™ Butterfly Valves

INSTALLATION OF THE ACTUATOR ADAPTER KIT

NOTICE

- The following instructions feature photos of a 6"/DN150 valve size. However, the same steps apply to all valve sizes.

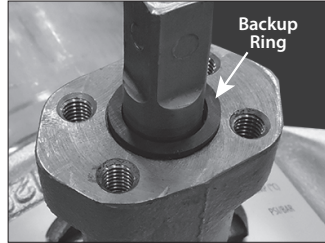
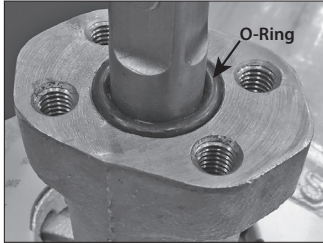

1. Verify that the o-ring and backup ring are still installed in the recess of the flange around the stem, as shown above (o-ring is installed under the backup ring).

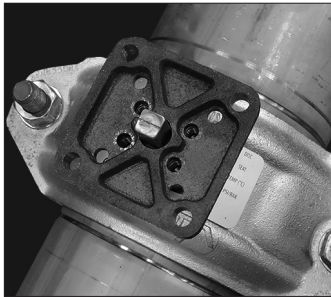

2. Place the actuator adapter plate over the stem. Align the holes of the actuator adapter plate with the holes in the flange.

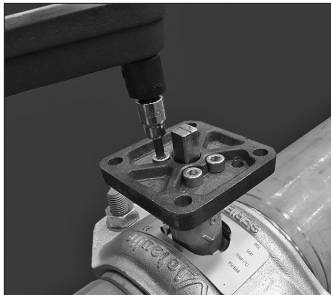

3. Apply thread-locking compound to the cap screws. Insert the cap screws to retain the actuator adapter plate to the flange. **Tighten each cap screw to 28 – 30 ft-lbs/38 – 41 N•m.**

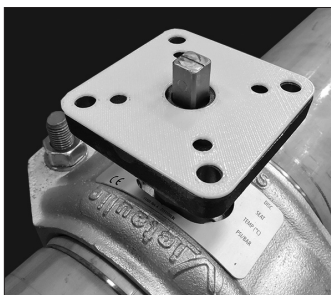

4. Place the thermal barrier over the stem. Align the holes of the thermal barrier with the holes in the actuator adapter plate.

5. The valve is now ready for mounting of the actuator. Always refer to the actuation manufacturer's instructions for complete information.

For complete contact information, visit victaulic.com

I-120.KIT 15742 REV A UPDATED 08/2020 Z000120KIT

VICTAULIC, INSTALLATION-READY, AND STRENGTHIN100 ARE REGISTERED TRADEMARKS OR TRADEMARKS OF VICTAULIC COMPANY AND/OR ITS AFFILIATED ENTITIES IN THE UNITED STATES AND/OR OTHER COUNTRIES. © 2020 VICTAULIC COMPANY. ALL RIGHTS RESERVED.