

Series 725 Diverter Valve

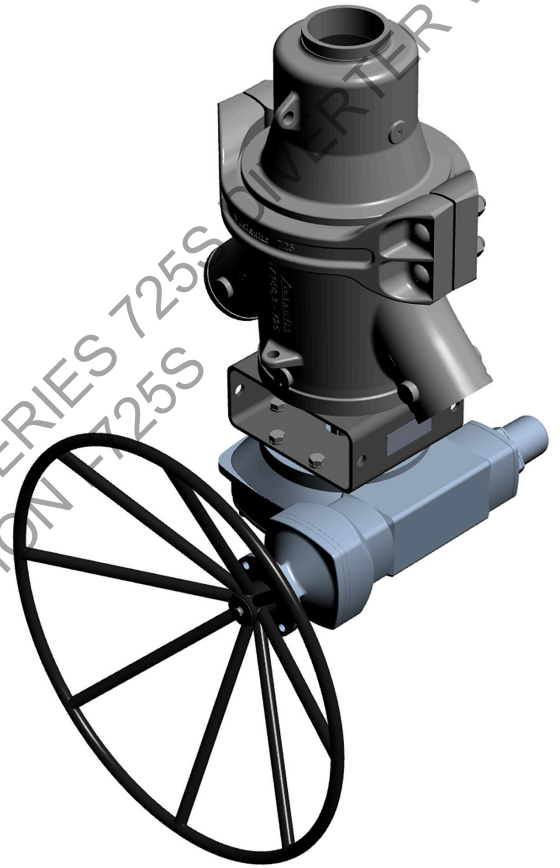

DISCONTINUED PRODUCT - REPLACED BY SERIES 725S
REQUEST PUBLICATION I-725S

⚠ WARNING					
<ul style="list-style-type: none"> • Read and understand all instructions before attempting to install, remove, adjust, or maintain any Victaulic piping products. • Depressurize and drain the piping system before attempting to install, remove, adjust, or maintain any Victaulic piping products. • Wear safety glasses, hardhat, foot protection, and hearing protection. <p>Failure to follow instructions and warnings could cause system failure, resulting in death or serious personal injury and property damage.</p>					

SERIES 725 DIVERTER VALVE COMPONENTS

NOTICE

- Drawings and/or pictures in this manual may be exaggerated for clarity.
- The product, along with these installation and maintenance instructions, contains trademarks, copyrights, and/or patented features that are the exclusive property of Victaulic.

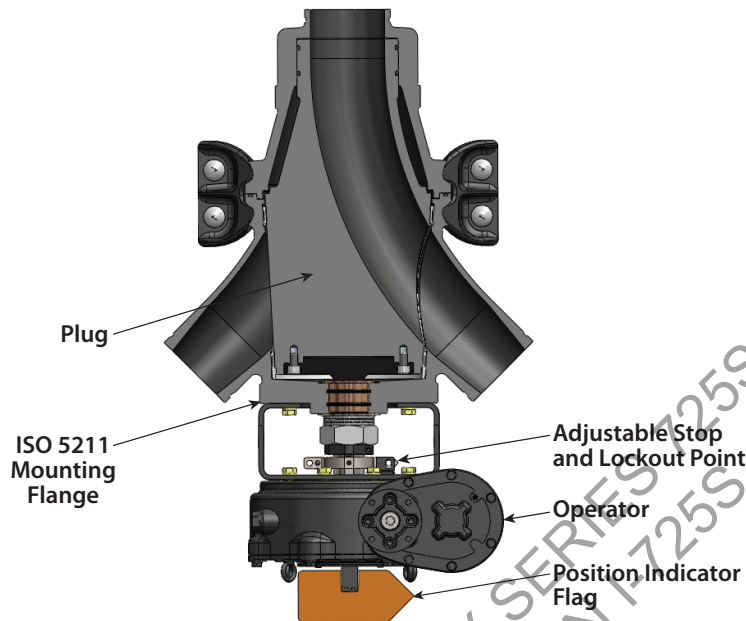

INSTALLATION INFORMATION

Series 725 Diverter Valves are designed with grooved ends for use with Victaulic Style HP-70/HP-70ES Rigid Couplings or Victaulic Style 77 Flexible Couplings. To prevent rotation in the system, Victaulic recommends installing the valve with at least one Victaulic rigid coupling. If two Victaulic flexible couplings are used, additional support may be required to prevent the valve from rotating. Refer to the instructions, supplied with the couplings, for proper installation.

- Series 725 Diverter Valves can be installed in the horizontal or vertical position or any intermediate position that allows for access to the actuator or gear operator.
- Series 725 Diverter Valves and connecting piping must be supported to prevent the joints from being subjected to bending loads, shear loads, or any other external loads.

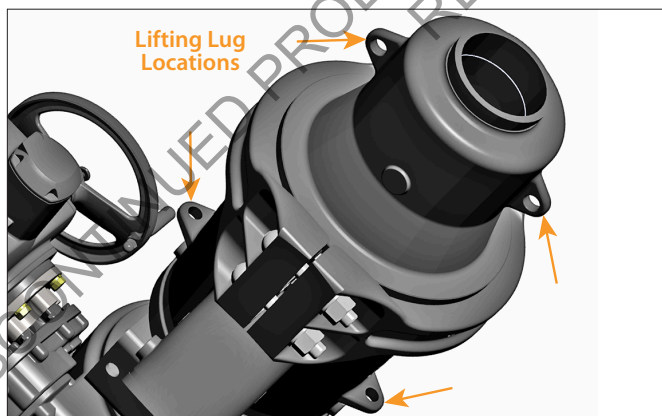

- Using a minimum of two lifting lug locations, support the valve to provide balanced loading. In addition, a cradle or cribbing can be utilized to provide the necessary support.
- **WELDING TO SERIES 725 DIVERTER VALVES AND COUPLINGS IS NOT PERMITTED.**

SERIES 725 WEIGHTS

Nominal Size inches	Actual Outside Diameter inches/mm	Approximate Weight pounds/kilograms		
		Valve With Electric Actuator	Valve With Pneumatic Actuator	Valve With Gear Operator
6	6.625 168.3	1250 567	1000 454	980 445

ELECTRIC OR PNEUMATIC ACTUATOR SETUP

Always refer to the electric or pneumatic actuator manufacturer's manual for complete setup and operating requirements.

VALVE OPERATION

WARNING

- **DO NOT** flow media in reverse of the flow arrow on the valve body.
- **DO NOT** index the valve with media in the system or while the valve is pressurized. To prevent permanent damage to internal valve components, the system must be depressurized, flushed, and free of paste before attempting to index the valve.

Failure to follow these instructions could cause valve damage and joint failure, resulting in serious personal injury and property damage.

- **DO NOT** flow media in reverse of the flow arrow on the valve body. If media flows in reverse of the flow arrow, there is an increased chance of wear due to a reduction of the interior diameter at the outlet.
- **DO NOT** index the valve with media in the system or while the valve is pressurized. To prevent permanent damage to internal valve components, the system must be depressurized, flushed, and free of paste before attempting to index the valve.

ASSEMBLY OF THE HANDWHEEL

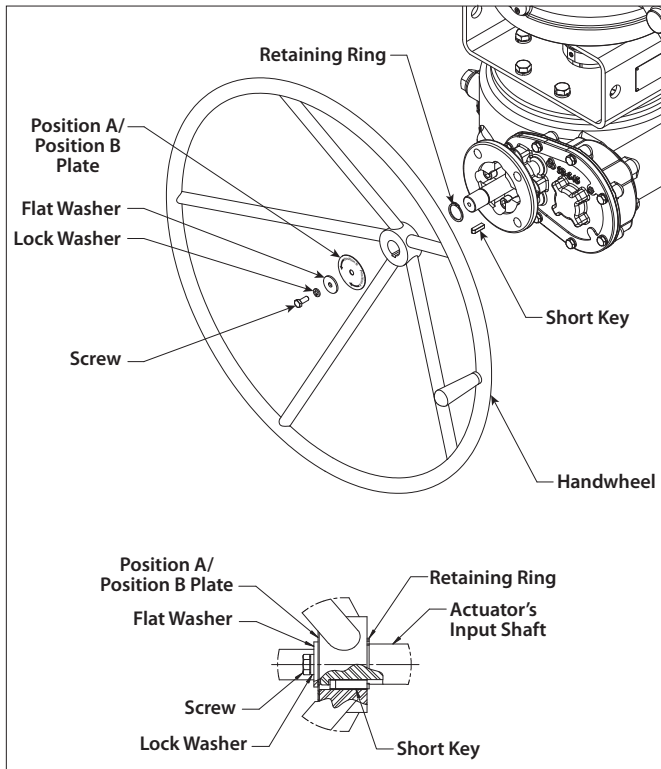

1. If the actuator's input shaft contains a long key, remove and discard the key.
2. Install the retaining ring over the actuator's input shaft, as shown above.
3. Install the short key, supplied with the handwheel kit, into the actuator's input shaft, as shown above.
4. Install the handwheel onto the actuator's input shaft with the slot in the handwheel's hub aligned with the short key in the actuator's input shaft.
5. Install the Position A/Position B plate, flat washer, lock-washer, and screw in the orientation shown above. **NOTE:** Make sure the markings on the Position A/Position B plate are facing outward (away from the actuator), as shown above.
6. Tighten the screw to retain the handwheel assembly to the actuator.

Series 725 Diverter Valve

DISCONTINUED PRODUCT - REPLACED BY SERIES 725S DIVERTER VALVE
REQUEST PUBLICATION I-725S

For complete contact information, visit victaulic.com

I-725 8605 REV A UPDATED 05/2015 Z000725000

VICTAULIC IS A REGISTERED TRADEMARK OF VICTAULIC COMPANY AND/OR ITS AFFILIATED ENTITIES IN THE UNITED STATES AND/OR OTHER COUNTRIES.
© 2015 VICTAULIC COMPANY. ALL RIGHTS RESERVED.

