

Series 751, 764, 768, and 769

INSTALLING ALARM KITS ONTO SERIES 751, 764, 768, AND 769 FIRELOCK® EUROPEAN FIRE PROTECTION VALVES

IMPORTANT INFORMATION

WARNING



- Read and understand all instructions before attempting to install, remove, adjust, or maintain any Victaulic piping products.
- Depressurize and drain the piping system before attempting to install, remove, adjust, or maintain any Victaulic piping products.
- Wear safety glasses, hardhat, and foot protection.
- Any activities that require taking the valve out of service may eliminate the fire protection provided.
- Before servicing or testing the system, notify the authority having jurisdiction.
- Consideration of a fire patrol should be given in the affected areas.

Failure to follow these instructions could result in serious personal injury and/or property damage.

REMOVING SERIES 751 FIRELOCK® EUROPEAN ALARM CHECK VALVES FROM SERVICE

1. Notify the authority having jurisdiction, remote station alarm monitors, and those in the affected area that the system is being taken out of service.
2. Close the water supply main control valve to take the system out of service.
3. Open the system main drain valve, and allow the system to drain completely. It may be necessary to open the remote system test valve (inspector's test connection) and any auxiliary drains in order to drain the system completely.

WARNING



- Make sure the valve is depressurized and drained before attempting to remove any trim from the valve.



Failure to follow this instruction could result in serious personal injury and/or property damage.

REMOVING SERIES 764, 768, AND 769 FIRELOCK NXT™ EUROPEAN VALVES FROM SERVICE

1. Notify the authority having jurisdiction, remote station alarm monitors, and those in the affected area that the system is being taken out of service.
2. Open the water supply main drain valve fully to flush the water supply of any contaminants.
3. Close the water supply main drain valve.
4. Close the water supply main control valve to take the system out of service.
5. Open the water supply main drain valve.
6. Confirm that water is not flowing from the water supply main drain valve.
7. Close the diaphragm-charge-line ball valve.
8. Open the system main drain valve to drain any water that has accumulated and to release system air pressure.

NOTE: If the system has operated, open the remote system test valve (inspector's test connection) and any auxiliary drain valves.

9. **SHUT OFF THE AIR SUPPLY, IF APPLICABLE.**

WARNING



- Make sure the valve is depressurized and drained before attempting to remove any trim from the valve.



Failure to follow this instruction could result in serious personal injury and/or property damage.

10. **PUSH DOWN ON THE AUTO DRAIN SCREW TO REMOVE PRESSURE IN THE DIAPHRAGM CHARGE LINE.**

Series 751, 764, 768, and 769

INSTALLING ALARM KITS ONTO SERIES 751, 764, 768, AND 769 FIRELOCK® EUROPEAN FIRE PROTECTION VALVES

ALARM LINE SUPERVISORY AND GAUGE KIT FOR 3 - 8-INCH/88.9 - 219.1-MM SERIES 751 FIRELOCK® EUROPEAN ALARM CHECK VALVES

1. Make sure the valve is completely depressurized and drained by following the "Removing Series 751 FireLock® Alarm Check Valves from Service" section on page 1.
2. Remove the trim from the back of the valve body. **NOTE:** Two of the existing nipples will be replaced by longer nipples (Items 3 and 4) provided in the kit, as noted in the drawing below.

3. Apply a small amount of pipe joint compound or Teflon* tape to the external threads of all threaded pipe connections contained in the kit. DO NOT get any tape, compound, or other foreign material into the pipe nipples.
4. Install the kit components, as noted in the drawing below.
5. Place the system back in service by following the "Placing the System in Service" section in the I-751.VDS Installation, Maintenance, and Testing Manual.

* TEFLON IS A REGISTERED TRADEMARK OF THE DUPONT COMPANY

Bill of Materials

Item	Qty.	Description
1	1	Gauge (½-inch NPT, 0 – 25 Bar)
2	1	Close Nipple (½-inch NPT x 1.13)
3	1	Nipple (½-inch NPT x 2.00)
4	1	Nipple (½-inch NPT x 3.00)
5	1	Nipple (½-inch NPT x 6.00)
6	1	Square-Head Pipe Plug (½-inch NPT)
7	1	Female Tee (½-inch NPT)
8	1	Gauge Valve (½-inch NPT)
9	1	Universal Ball Valve Switch

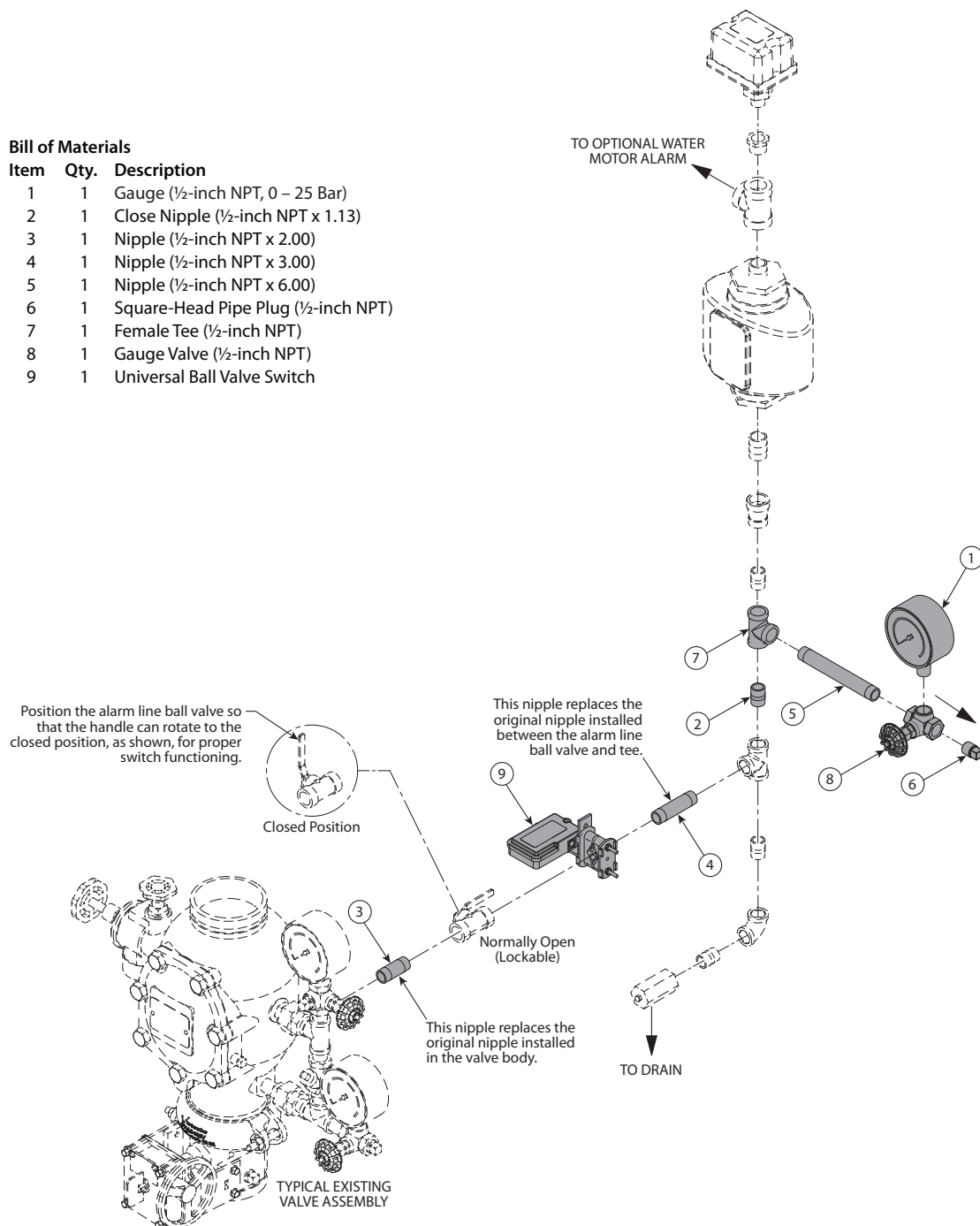

Series 751, 764, 768, and 769

INSTALLING ALARM KITS ONTO SERIES 751, 764, 768, AND 769 FIRELOCK® EUROPEAN FIRE PROTECTION VALVES

SUPERVISED ALARM LINE (TWO ALARM SWITCHES) KIT FOR 3 - 8-INCH/88.9 - 219.1-MM SERIES 751 FIRELOCK® EUROPEAN ALARM CHECK VALVES

1. Make sure the valve is completely depressurized and drained by following the "Removing Series 751 FireLock® Alarm Check Valves from Service" section on page 1.
2. Remove the trim from the back of the valve body. **NOTE:** Item 2, provided in the kit, will replace the existing nipple, as noted in the drawing below.
3. Apply a small amount of pipe joint compound or Teflon* tape to the external threads of all threaded pipe connections contained in the kit. DO NOT get any tape, compound, or other foreign material into the pipe nipples.
4. Install the kit components, as noted in the drawing below.
5. Place the system back in service by following the "Placing the System in Service" section in the I-751.VDS Installation, Maintenance, and Testing Manual.

* TEFLON IS A REGISTERED TRADEMARK OF THE DUPONT COMPANY

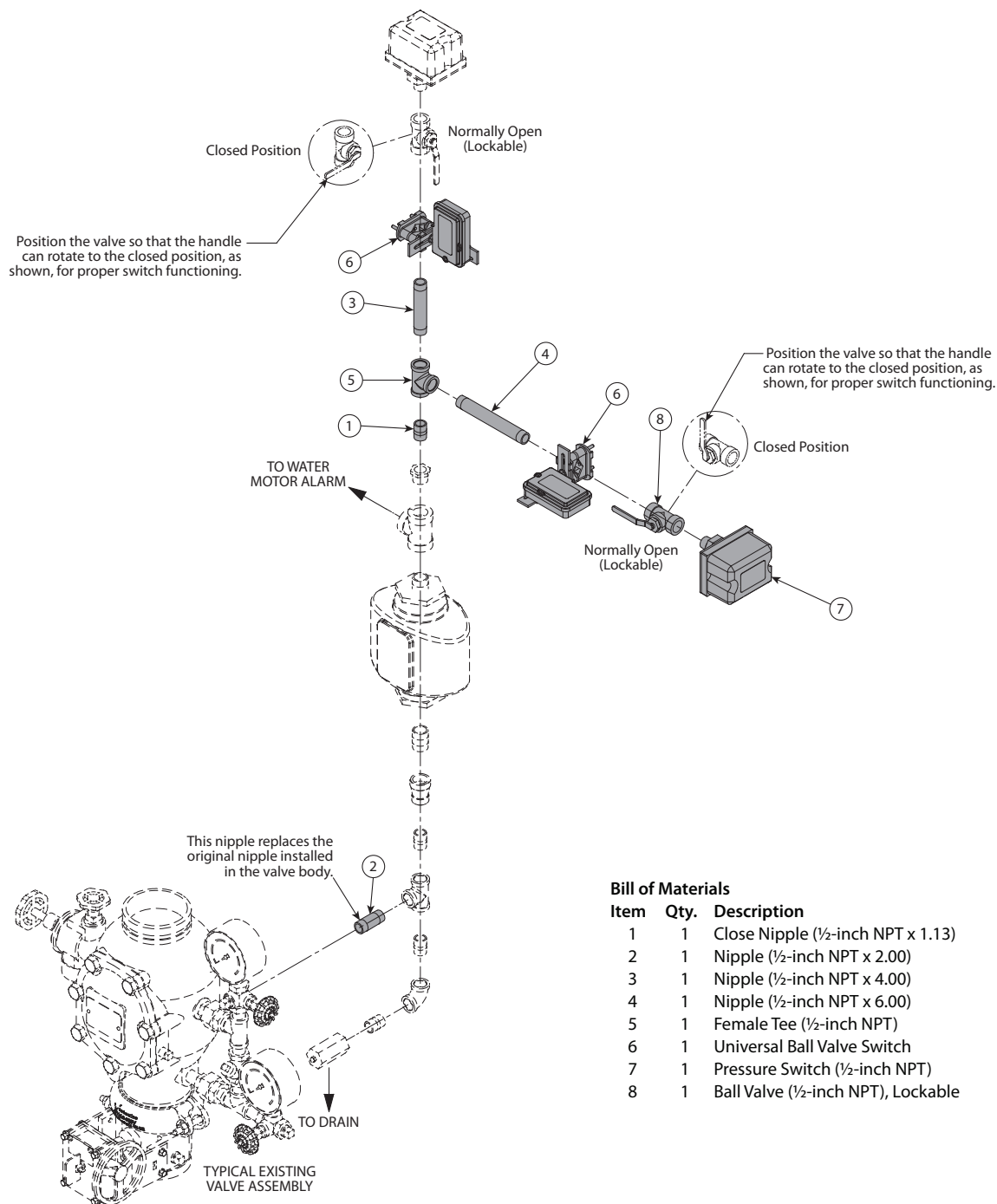

Bill of Materials

Item	Qty.	Description
1	1	Close Nipple (½-inch NPT x 1.13)
2	1	Nipple (½-inch NPT x 2.00)
3	1	Nipple (½-inch NPT x 4.00)
4	1	Nipple (½-inch NPT x 6.00)
5	1	Female Tee (½-inch NPT)
6	1	Universal Ball Valve Switch
7	1	Pressure Switch (½-inch NPT)
8	1	Ball Valve (½-inch NPT), Lockable

Series 751, 764, 768, and 769

INSTALLING ALARM KITS ONTO SERIES 751, 764, 768, AND 769 FIRELOCK® EUROPEAN FIRE PROTECTION VALVES

ALARM LINE SUPERVISORY AND GAUGE KIT FOR 1½ - 8-INCH/48.3 - 219.1-MM SERIES 764, 768, AND 769 FIRELOCK NXT™ EUROPEAN VALVES

1. Make sure the valve is completely depressurized and drained by following the "Removing Series 764, 768, and 769 FireLock NXT™ Valves from Service" section on page 1.
2. Remove the pipe plug from the tee that contains the drip check assembly, as shown in the drawing below. **NOTE:** The pipe plug will need to be re-located in later steps.
3. Remove the bell reducer from the water motor alarm shutoff valve, as noted in the drawing below.
4. Remove the water motor alarm shutoff valve. **NOTE:** The water motor alarm shutoff valve will need to be re-located in later steps, as noted in the drawing below.
5. Re-install the bell reducer, removed in step 3, into the tee that contains the drip check assembly (in the location from where the water motor alarm shutoff valve was removed).
6. Apply a small amount of pipe joint compound or Teflon* tape to the external threads of all threaded pipe connections contained in the kit. DO NOT get any tape, compound, or other foreign material into the pipe nipples.
7. Install the kit components, as shown in the drawing below. Re-locate the water motor alarm shutoff valve and pipe plug, as noted.
8. Place the system back in service by following the "Placing the System in Service" section of the applicable Installation, Maintenance, and Testing Manual.

* TEFLON IS A REGISTERED TRADEMARK OF THE DUPONT COMPANY

Bill of Materials

Item	Qty.	Description
1	1	90° Female Elbow (½-inch NPT)
2	1	Gauge (½-inch NPT, 0 – 25 Bar)
3	1	Nipple (½-inch NPT x 1.50)
4	3	Nipple (½-inch NPT x 2.00)
5	1	Nipple (½-inch NPT x 2.50)
6	1	Pressure Switch (½-inch NPT)
7	1	Straight Coupling (½-inch NPT x ½-inch NPT)
8	1	Female Tee (½-inch NPT)
9	1	Gauge Valve (½-inch NPT)
10	1	Universal Ball Valve Switch

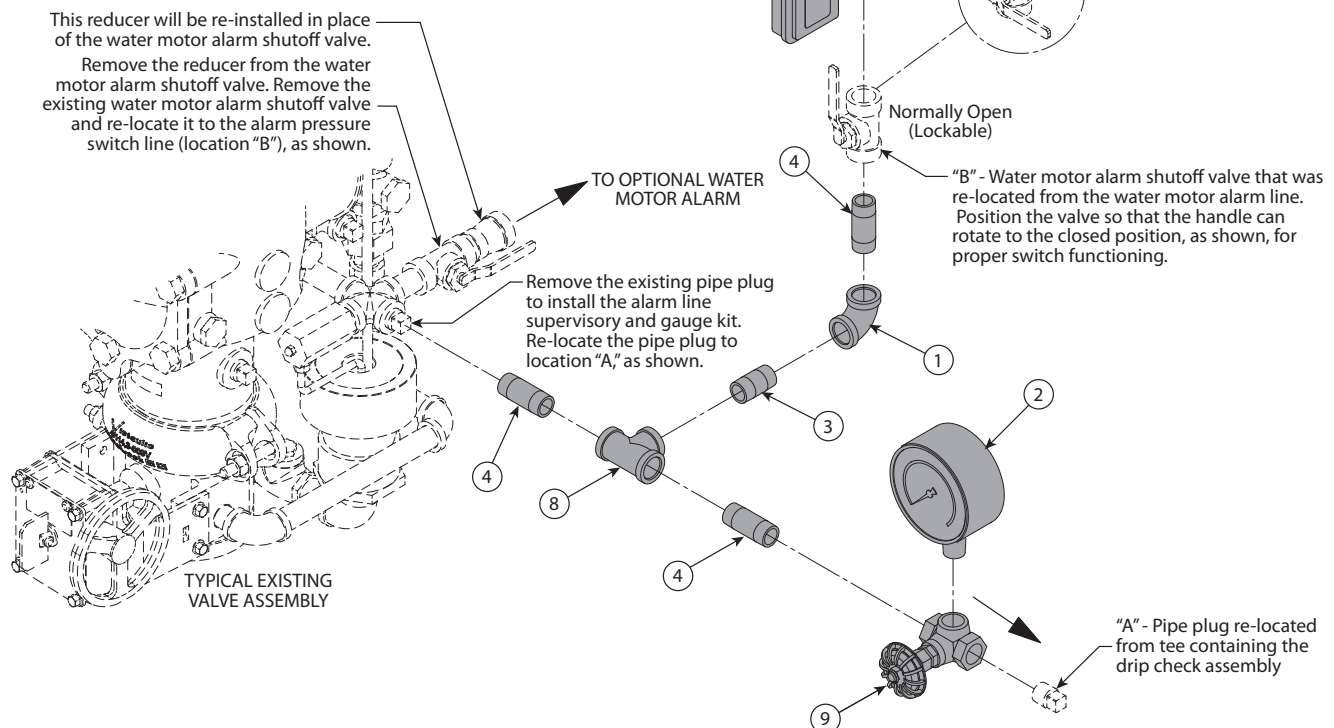

Series 751, 764, 768, and 769

INSTALLING ALARM KITS ONTO SERIES 751, 764, 768, AND 769 FIRELOCK® EUROPEAN FIRE PROTECTION VALVES

SUPERVISED ALARM PRESSURE SWITCH (TWO ALARM SWITCHES) KIT FOR 1½ - 8-INCH/48.3 - 219.1-MM SERIES 764, 768, AND 769 FIRELOCK NXT™ EUROPEAN VALVES

1. Make sure the valve is completely depressurized and drained by following the "Removing Series 764, 768, and 769 FireLock NXT™ Valves from Service" section on page 1.
2. Remove the pipe plug from the tee that contains the drip check assembly, as shown in the drawing below.
3. Remove the bell reducer from the water motor alarm shutoff valve, as noted in the drawing below.
4. Remove the water motor alarm shutoff valve. **NOTE:** The water motor alarm shutoff valve will need to be re-located in later steps, as noted in the drawing below.
5. Re-install the bell reducer, removed in step 3, into the tee that contains the drip check assembly (in the location from where the water motor alarm shutoff valve was removed).
6. Apply a small amount of pipe joint compound or Teflon* tape to the external threads of all threaded pipe connections contained in the kit. DO NOT get any tape, compound, or other foreign material into the pipe nipples.
7. Install the kit components, as shown in the drawing below. Re-locate the water motor alarm shutoff valve, as noted.
8. Place the system back in service by following the "Placing the System in Service" section of the applicable Installation, Maintenance, and Testing Manual.

* TEFLON IS A REGISTERED TRADEMARK OF THE DUPONT COMPANY

Bill of Materials

Item	Qty.	Description
1	1	Ball Valve (½-inch NPT), Lockable
2	2	90° Female Elbow (½-inch NPT)
3	1	Nipple (½-inch NPT x 1.50)
4	2	Nipple (½-inch NPT x 2.00)
5	2	Nipple (½-inch NPT x 4.00)
6	2	Pressure Switch (½-inch NPT)
7	1	Female Tee (½-inch NPT)
8	2	Universal Ball Valve Switch

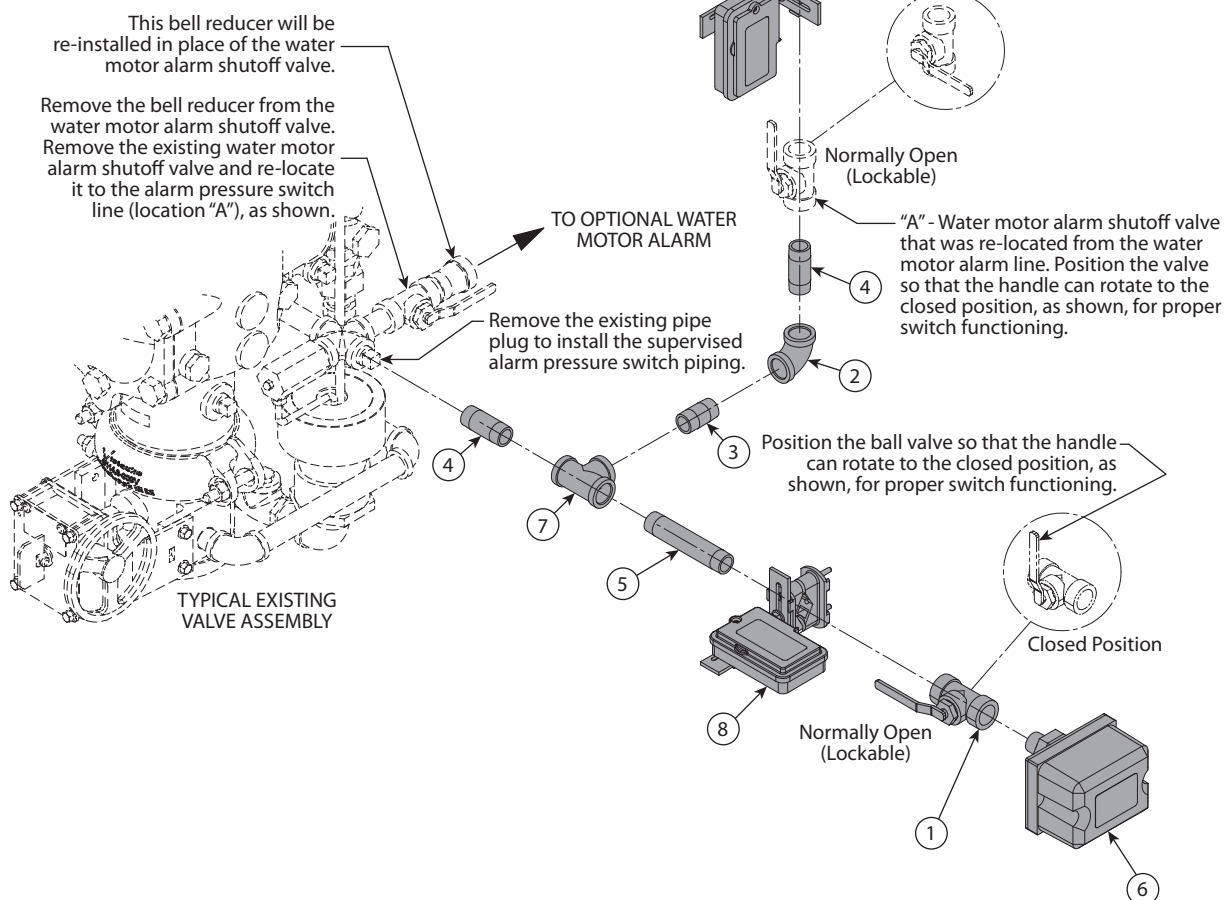

Series 751, 764, 768, and 769

INSTALLING ALARM KITS ONTO SERIES 751, 764, 768, AND 769 FIRELOCK® EUROPEAN FIRE PROTECTION VALVES

For complete contact information, visit www.victaulic.com

I-751/NXT.KIT 5416 REV B UPDATED 05/2011

VICTAULIC IS A REGISTERED TRADEMARK OF VICTAULIC COMPANY. © 2011 VICTAULIC COMPANY. ALL RIGHTS RESERVED. PRINTED IN THE USA.

I-751/NXT.KIT

