

---

## VAPS112 Pipe Stand

---



---

### PARTS ORDERING INFORMATION

When ordering parts, the following information is necessary for Victaulic to process the order promptly:

1. Tool Model Number – VAPS112
2. Tool Serial Number – The Serial Number can be found on the side of the tool.
3. Quantity\*, Item Number, Part Number, Description
4. Where to send the part(s) – Company Name and Address
5. To whose attention to send the part(s)
6. Purchase Order Number

Parts may be ordered from your nearest Victaulic Sales Office.

\* Quantity given in **Qty.** column indicates total number of pieces required per tool. Value of "A/R" indicates "As Required" which may differ based on usage and environment.

VAPS112 MAIN ASSEMBLY

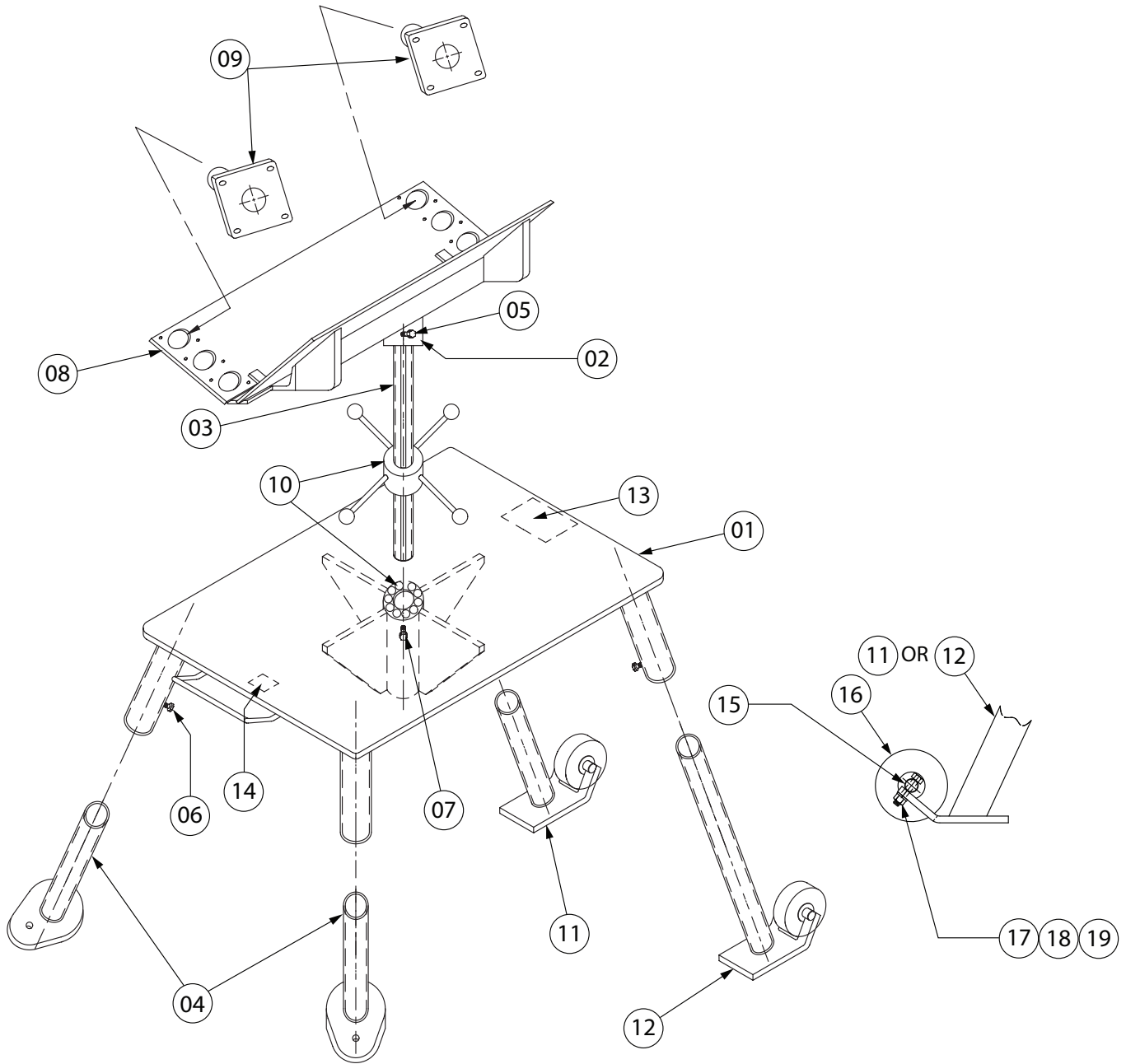

**VAPS112 BODY COMPONENT ASSEMBLIES**

**MAIN COMPONENTS**

Item #	Part #	Qty.	Description
01	R001112PNT	1	Table
02	R002112MAC	1	Spacer
03	R003112MAC	1	Adjusting Rod
04	R004112PLT	2	Stationary Leg
08	R120112PNT	1	Pipe Trough
09	NMSC000042	4	Ball Transfer Subassembly
10	R350112PS0	1	Adjusting Nut Subassembly with Bearing
13	R031272LAB	1	Warning Label
14	R513127LBL	1	Name Plate, Blank

**ROLLER LEG ASSEMBLY, LEFT**

Item #	Part #	Qty.	Description
	R100112KIT	1	Roller Leg Assembly, Left
11	*	1	Roller Leg, LH
15	*	1	Axle
16	*	1	Wheel
17	*	2	Hex Head Screw, 5/16-18 UNC x 1.5" LG, PLTD
18	*	2	Standard Lock Washer, 5/16", PLTD
19	*	2	Standard Hex Nut, 5/16-18 UNC, PLTD

\* Included in assembly. Not available for individual sale.

**WHEEL KIT**

Item #	Part #	Qty.	Description
	R300112KIT	1	Wheel Kit
15	*	1	Axle
16	*	1	Wheel
17	*	2	Hex Head Screw, 5/16-18 UNC x 1.5" LG, PLTD
18	*	2	Standard Lock Washer, 5/16", PLTD
19	*	2	Standard Hex Nut, 5/16-18 UNC, PLTD

\* Included in assembly. Not available for individual sale.

**ROLLER LEG ASSEMBLY, RIGHT**

Item #	Part #	Qty.	Description
	R200112KIT	1	Roller Leg Assembly, Right
12	*	1	Roller Leg, RH
15	*	1	Axle
16	*	1	Wheel
17	*	2	Hex Head Screw, 5/16-18 UNC x 1.5" LG, PLTD
18	*	2	Standard Lock Washer, 5/16", PLTD
19	*	2	Standard Hex Nut, 5/16-18 UNC, PLTD

\* Included in assembly. Not available for individual sale.

**HARDWARE KIT**

Item #	Part #	Qty.	Description
	R400112KIT	1	Hardware Kit
05	*	2	Socket Head Cap Screw, 3/8-16 UNC x 1" LG, BLK OX
06	*	4	Hex Head Cap Screw, 5/16-18 x 1" LG, PLTD
07	*	1	Socket Head Cap Screw, 5/16-18 UNC x 1" LG, BLK OX

\* Included in assembly. Not available for individual sale.

## VAPS112 Pipe Stand

IMAGES OF THE LABELS ON THIS PAGE ARE NOT TO SCALE.

## R513127LBL

	
Victaulic Company World Headquarters 4901 Kesslersville Road Easton, PA 18040 victaulic.com	
<b>MODEL</b>	
<input style="width: 100%; height: 20px;" type="text"/>	
<b>SERIAL NO.</b>	
<input style="width: 100%; height: 20px;" type="text"/>	
<b>DATE MFD.</b>	
<input style="width: 100%; height: 20px;" type="text"/>	
Manufactured in China	
13127 Rev. A	R513127LBL

## R031272LAB

 <b>WARNING</b>	
	<p><b>Failure to follow instructions and warnings could result in death, serious personal injury, property damage, and/or product damage.</b></p> <ul style="list-style-type: none"> <li>• Before operating or servicing any tools, read the entire operating and maintenance instructions manual and all labels on the tool.</li> </ul>
<ul style="list-style-type: none"> <li>• Wear safety glasses, hardhat, foot protection, and hearing protection.</li> <li>• Operate the tool only with a safety foot switch. If the tool does not contain a safety foot switch, contact Victaulic.</li> </ul>	
Contact Victaulic with questions regarding the safe and proper operation of tools:	
<b>Web:</b> victaulic.com <b>E-Mail:</b> pickvic@victaulic.com <b>Phone:</b> 1-800-PICK-VIC	
<small>0567 Rev. E</small>	<small>R031272LAB</small>

For complete contact information, visit [victaulic.com](http://victaulic.com)

RP-VAPS112 4312 REV C UPDATED 10/2021 RPL0112000

VICTAULIC IS A REGISTERED TRADEMARK OF VICTAULIC COMPANY. © 2021 VICTAULIC COMPANY. ALL RIGHTS RESERVED.

